

# LZB-600-R10 Cubic Shape Vacuum Packer

## i. Applications

Used for the quantitative brick shape vacuum packaging in the industry of rice, grains, peanuts, and food etc.

## ii. Technical parameters:

Model	LZB-600-R10
Weighing extent (kg)	0.5-5
Speed(bags/h) (bags/hour)	540-600
Scale Interval(gram)	1
Precession grade	X(0.5)
Power	4N-AC 380V 50Hz 4.5KW
Air , air consumption	0.4-0.6MPa 6m <sup>3</sup> /h (supplied by the customer)
Height (mm)	2500

## iii. Main Configures :

NO.	Name:	Main Configures
1	Touch screen 10"	Japan / Omron
2	Weighing controller	Canada/General
3	PLC	Japan / Omron
4	Switching Power Supply	Japan / Omron
5	Solid state relay	Japan / Omron
6	Intermediate relay	Japan / Omron
7	Load cell	USA/VPG
8	Phase sequence protection relay	France / Schneider
10	Vacuum pump	Germany/ (BECKER)
11	Cylinder	Japan /SMC
12	Solenoid valve	Japan /SMC
13	Linear Slides	Taiwan/ABBA

## iv. Functions and Features

- New generation of high-speed weighing control mode parameter automatic correction, adaptive weighing process various materials;
- Omron touch screen, Omron PLC centralized control, intelligent control weighing, filling, six-sided plastic,
- Vacuum, heat sealing, unloading bags, the whole process of transportation, real-time tracking

system working state, friendly interface, easy to operate;

- imported from Japan, SMC pneumatic components, high reliability and long service life;
- imported from Germany, vacuum pumps, stable and reliable;
- device with fault self-test function, maintenance is simple and convenient;
- intelligent control information presentation system;
- Automatic Bag interface reserved.
- Reserve RS232/485



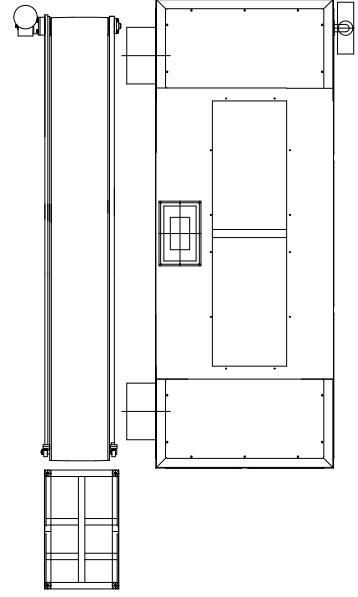
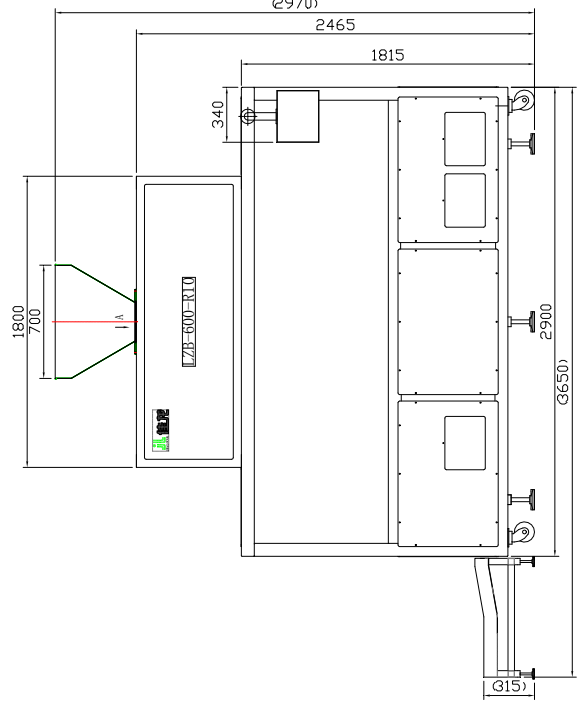
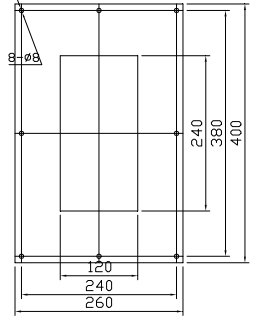
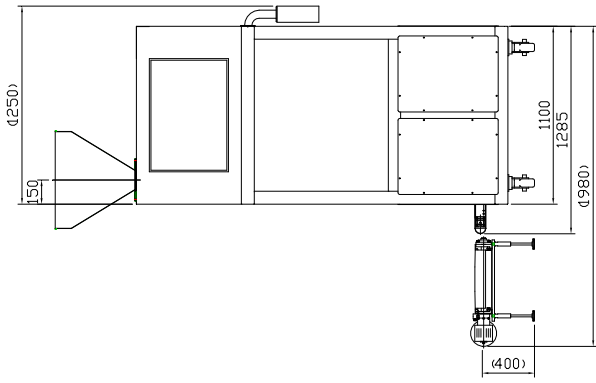

单位: mm

漳州佳龙 科技股份有限公司		产品安装图		LZB-600-R10	
设计	审核	分区	更改文件号	签名	年、月、日
绘图	标准	阶段	数量	比例	
工艺	批准		1	1:25	
			共 1 张 第 1 张		